

building
forever
furniture

VISTA assembly manual



invincible™

Assembly of Vista Style Tables

NON-HANDED LEGS

- 1.) Attach back panel to appropriate end panel.
- 2.) Bottom of legs are made by installing glide holder at back of leg: and inserting floor glides.
- 3.) Top of leg is made by installing small clip at front and on inside near access hole.

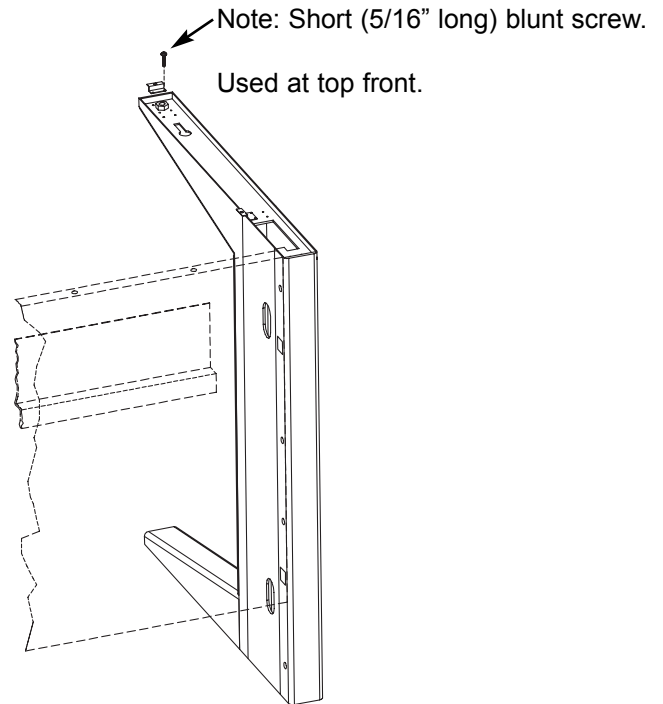
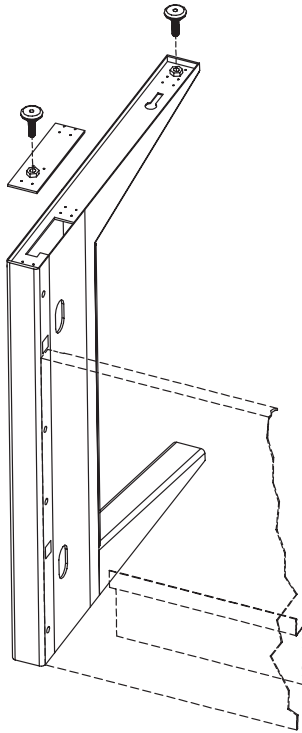

NON-HANDED END PANELS

- 1.) Attach back panel to appropriate end panels.
- 2.) Attach holders and floor glides same as legs above.
- 3.) Top attaches to end panel using keyhole slot.
- 4.) Push cover away to access bolt in top.

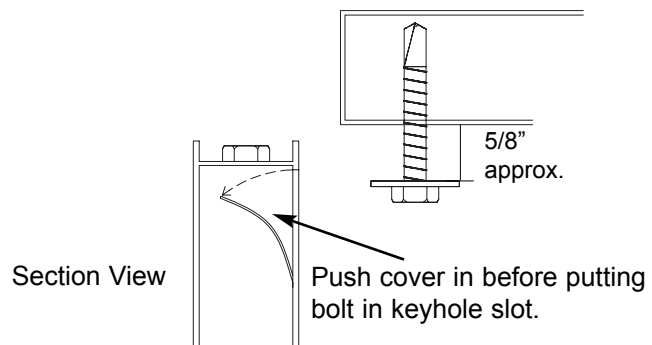
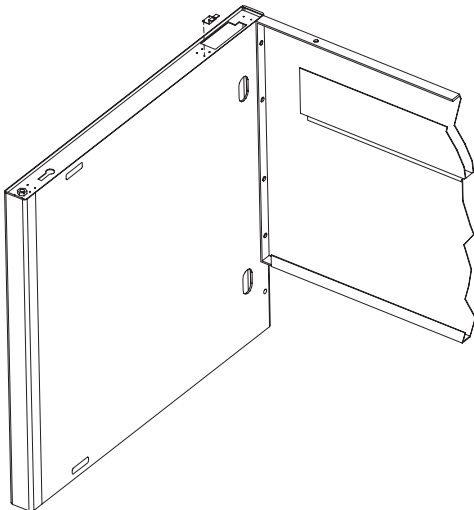

Assembly of Vista Style Tables

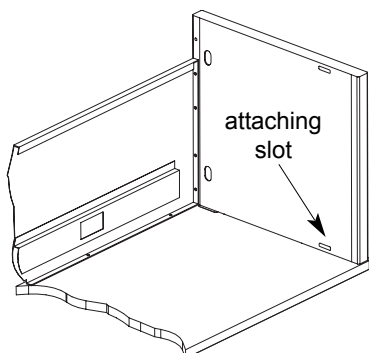
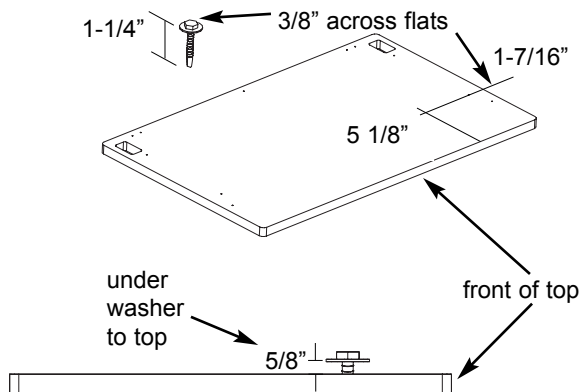
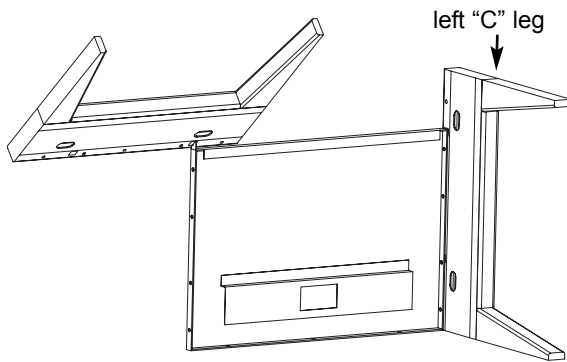
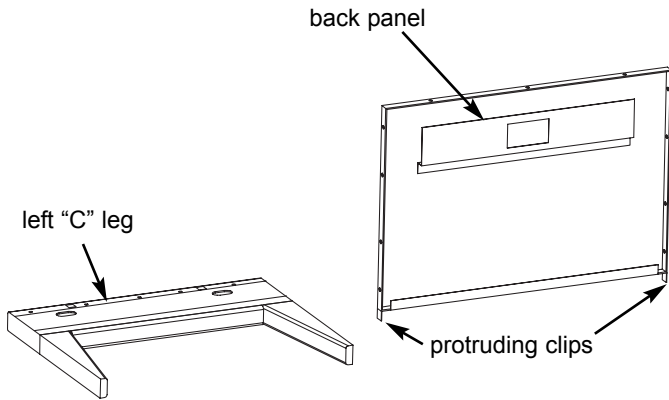

1. Assembly of table begins with placing top onto clean surface, bottom side up.
2. Determine style of end panel and back panel required to make table; place protruding clip of back panel into slot in end panel and rotate back panel onto end panel. Install #8 x 5/8 long sheet metal screws into aligning holes.

Set that assembly onto floor as shown at left. Bring appropriate end panel into position shown and rotate end panel slot onto clip of back panel. Then lower end panel until holes align and insert #8 x 5/8 screws.

3. Attach assembled chassis to table top with #8 x 1" long screws (Not Longer). If holes were not pre-drilled at factory, place edge of end panel 7/16" from end edge of table top, and back of end panel 1/4" from back edge of table top and drive screws into woodcore top with power screwdriver. Pre-drilled 1/8" dia. holes are best for guiding screws, but care must be used not to drill through top.

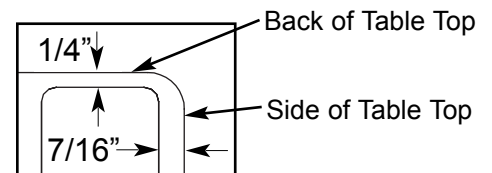

Installation of "Full End Panel"

4. Invert top onto clean flat surface with attachment holes upward.

Wrench 1-1/4" long hex. 3/8" dia. washer head screw into pilot hole located 5-1/8" from front edge and 1-7/16" in from side edge leaving 5/8" from underside of washer headed screw to bottom of top.

Assemble back panel to end panels then place assembly onto top with washer headed screw inserting into keyhole shape piercing in top holder portion of full end panel. Slide end panel backward catching washer headed screw.

Side attaching slots allow vision of catching procedure and also provides opening for insertion of open end wrench to tighten down washer headed screw after chassis has been moved around on top to find favorable and equal overhang spacing. Back of end panel should be 1/4" from back edge of top and 7/16" from side.

Note: Corners of leg will be very close to radius corner of top.



invincible™

872 South 26th Street
PO Box 1117
Manitowoc, WI 54221-1117

(V) 877 682 4601
(F) 920 683 2970

www.InvincibleFurniture.com
Sales@InvincibleFurniture.com

building forever furniture